

UTEPO

PRODUCT CATALOGUE



NW100

4 Port unmanaged 10/100Mbps PoE switch with 2 Port RJ45C 10/100Mbps Uplink



Item	Description	
Model 4 Ports PoE Ethernet Switch		
Power	Power Supply	Power Adaptor Input
	Voltage Range	DC48V~57V
	Consumption	The Equipment<5W,PoE output<60W
Ethernet	Speed	1-4 Ethernet Port: 10/100Mbps Uplink Port: 10/100Mbps
	Transmission Distance	Down Link Port:0-100m Uplink Port: Single Module Double Fiber Up to 20km (can transfer optical module)
Network Switch	Ethernet Standard	Support IEEE802.3/802.3u/802.3x/802.1p/802.1q/IEEE802.3 af/at
	Backplane Bandwidth	1G
	Packet Forwarding Rate	0.75Mbps
	Packet Buffer	768k
	MAC	2k
Status Indicator	Power Light	1pc(red)
	Ethernet Port Light	Yellow Indicates PoE, Green Indicates Act/link
	Optical Light	1 pc(green)
Protection Level	Surveillance Module Light	1 pc green on Indicates the Surveillance Module Start
	Pluse Group	Level 2 Standard:IEC61000-4-4
	ESD	1a Contact Discharge Level 2 1b Air Discharge Level 2 Standard : IEC61000-4-2
Working Environment	Anti-thunder Level	Level 2 Standard:IEC61000-4-5
	Working Temperature	0°C ~ 55°C
	Storage Temperature	-40°C ~ 85°C
	Humidity(Non-condensing)	0 ~ 95%
Mechanical	Dimension(L*W*H) Include Port	135mm*103mm*27mm
	Out Shell	Galvanized Sheet
	Color	Black
	Net Weight	315g
Stability	MTBF	≥50000h

Board Diagram

Front board

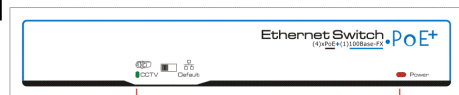

Back board

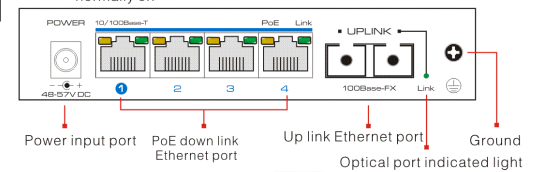

Side board

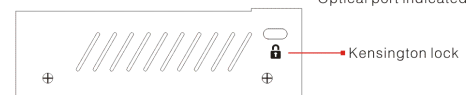

Application

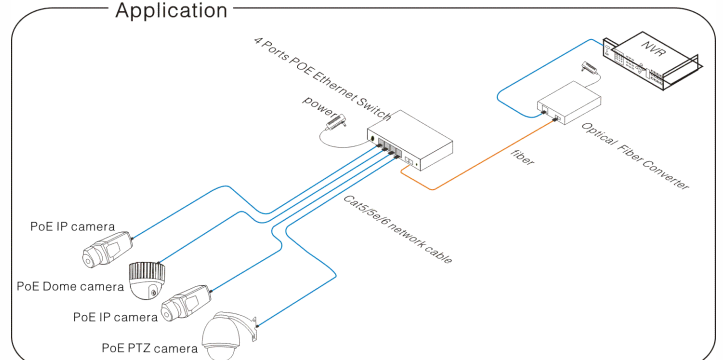

NW110-2

8 Port unmanaged industrial 10/100Mbps PoE Switch with 1 x RJ45 10/100Mbps Uplink



Item	Description	
Model 8 Ports PoE Ethernet Switch		
Power	Power Supply	Power Adaptor Input
	Voltage Range	DC48V-57V
	Consumption	The Equipment<5W,PoE output<120W
Ethernet	Speed	1-8 Ethernet Port: 10/100Mbps Uplink Port: 10/100Mbps
	Transmission Distance	Down Link Port:0-100m Uplink Port:0-100m
Network Switch	Ethernet Standard	Support IEEE802.3/802.3u/802.3x/802.1p/802.1q/IEEE802.3af/at
	Backplane Bandwidth	1.8G
	Packet Forwarding Rate	1.34Mbps
	Packet Buffer	768k
	MAC	2k
Status Indicator	Power Light	1 pc(red)
	Ethernet Port Light	RJ45port 2 pcs yellow Indicates PoE, green Indicates Act/link
	Surveillance Module Light	1 pc(green)
Protection Level	Pluse Group	Level 2 Standard:IEC61000-4-4
	ESD	1a Contact Discharge Level 2
		1b Air Discharge Level 2 Standard : IEC61000-4-2
Anti-thunder Level	Level 2 Standard : IEC61000-4-5	
Working Environment	Working Temperature	0°C ~ 55°C
	Storage Temperature	-40°C ~ 85°C
	Humidity(Non-condensing)	0 ~ 95%
Mechanical	Dimension(L*W*H) Include Port	200mm*105mm*27mm
	Out Shell	Galvanized Sheet
	Color	Black
	Weight	500g
Stability	MTBF	≥50000h

Board Diagram

Front board

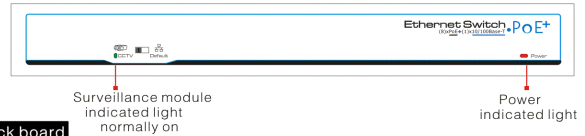

Back board

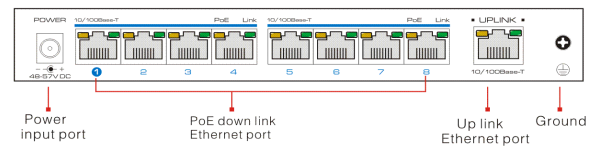

Side board



Application

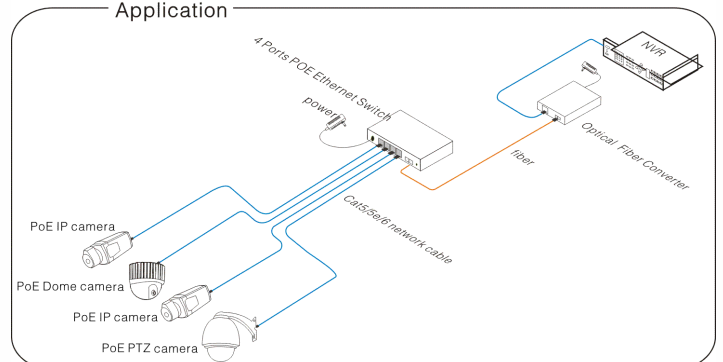

NW110-4

8 Port unmanaged industrial 10/100Mbps PoE Switch with 1 x RJ45 10/100/1000Mbps and 1 x SFP 1000Mbps Uplink



Item	Description	
	Model	4 Ports PoE Ethernet Switch
Power	Power Supply	Power Adaptor Input
	Voltage Range	DC48V~57V
	Consumption	The Equipment<5W,PoE output<60W
Ethernet	Speed	1-4 Ethernet Port: 10/100Mbps Uplink Port: 10/100Mbps
	Transmission Distance	Down Link Port:0-100m Uplink Port: Single Module Double Fiber Up to 20km (can transfer optical module)
Network Switch	Ethernet Standard	Support IEEE802.3/802.3u/802.3x/802.1p/802.1q/IEEE802.3 af/at
	Backplane Bandwidth	1G
	Packet Forwarding Rate	0.75Mbps
	Packet Buffer	768k
Status Indicator	MAC	2k
	Power Light	1pc(red)
	Ethernet Port Light	Yellow Indicates PoE, Green Indicates Act/link
	Optical Light	1 pc(green)
Protection Level	Surveillance Module Light	1 pc green on Indicates the Surveillance Module Start
	Pluse Group	Level 2 Standard:IEC61000-4-4
	ESD	1a Contact Discharge Level 2 1b Air Discharge Level 2 Standard : IEC61000-4-2
Working Environment	Anti-thunder Level	Level 2 Standard:IEC61000-4-5
	Working Temperature	0°C ~ 55°C
	Storage Temperature	-40°C ~ 85°C
Mechanical	Humidity(Non-condensing)	0 ~ 95%
	Dimension(L*W*H) Include Port	135mm*103mm*27mm
	Out Shell	Galvanized Sheet
	Color	Black
Stability	Net Weight	315g
	MTBF	≥50000h

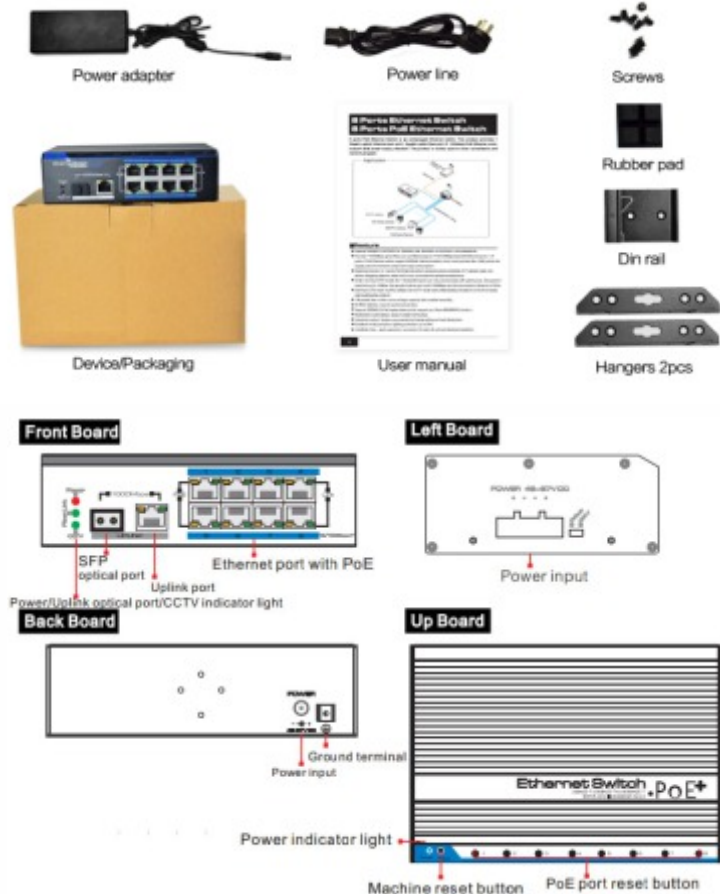

CONTACT US



087 802 CCTV (2288)



sales@reditron.co.za



www.reditron.co.za



JOHANNESBURG (HEAD OFFICE)

9 Electron Road, Linbro Business Park, Sandton
Tel: 087 802 CCTV (2288)



NELSPRUIT

Unit 4B, Waterfall Park,
17 Rapid Street, Riverside Industrial
Tel: 087 150 5517/8



CAPE TOWN

Unit 2, 7 Gold Street, Northgate Estate,
Maitland
Tel: 021 551 5841



PORT ELIZABETH

84 Pickering Street, Newton Park
Tel: 041 373 0395



DURBAN

Unit 9, 80 Rinaldo Road, Glen Anil
Tel: 031 263 1515

